

# Southwood Plaza

816 S Main Street, Bowling Green, OH 43402  
Wood County



## HIGHLIGHTS

For Lease  
County: Wood  
Type: Retail  
Total SF: 79,656  
Market: Bowling Green

## CONTACT

Chad Greeley  
419-843-6265  
cgreeley@tolsonent.com

Bradley Koltz  
419-843-6265  
bkoltz@tolsonent.com

Anchored by Big Lots and Ashley Furniture Homestore, Southwood Plaza is a 83,000 square foot neighborhood center located on the busiest stretch of State Route 25 in Bowling Green, Ohio. With daily traffic counts exceeding 19,000 cars per day (2015) you'll find no other area more traversed in the city than in front of this well known plaza according to Toledo Metropolitan Area Council of Governments. Excellent unobstructed road visibility, signage, and signalized access have made Southwood Plaza a strong retail, service, and restaurant site within the Bowling Green market for many years. The plaza borders Black Swamp Preserve with access to Slippery Elm Trail <https://www.wcparks.org/parks/slippery-elm-trail/>, which is a 13 mile long multi use trail ending in North Baltimore making this plaza an excellent trail head. Many successful tenants have enjoyed years and years of continued sales growth and choose to remain at this timeless location most convenient to the city's population base and workforce.

## DEMOGRAPHICS

### 3 MILES

### 5 MILES

### 10 MILES

Population	33,129	36,761	55,251
Households	12,247	13,555	20,354
Average Household Income (\$)	88,124	88,271	90,193
Median Household Income (\$)	78,840	77,026	78,492

## RETAILERS INCLUDE



# Southwood Plaza

816 S Main Street, Bowling Green, OH 43402  
Wood County

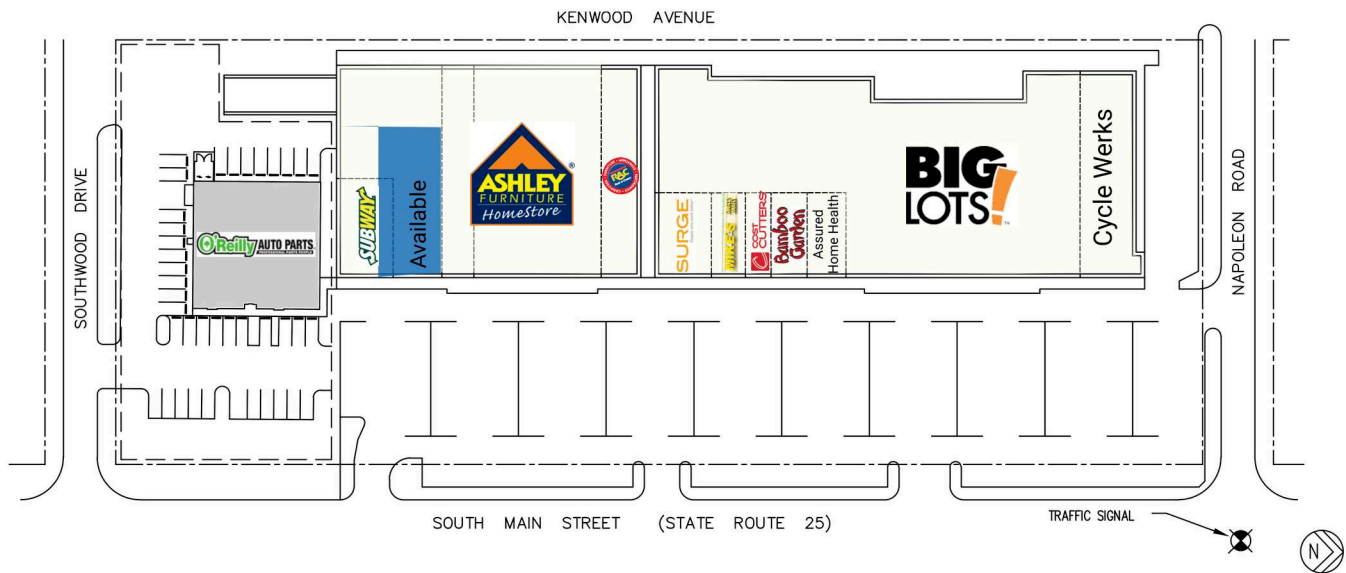

816	Cycle Werks	6,000 SF	836	Surge Staffing	1,872 SF
818	Big Lots	33,600 SF	838	Rent A Center	4,200 SF
826	Assured Home Health	1,666 SF	840/848	Ashley Furniture Homestore	20,000 SF
828	Bamboo Garden	1,522 SF	<b>852</b>	<b>Available</b>	<b>5,610 SF</b>
832	Cost Cutters	1,080 SF	854	Subway	2,666 SF
834	Mike's Party Mart	1,440 SF			